



**GRANITE**  
INDUSTRIES

**A M E R I C A N**  
**C A R T & R A C K**

MANUFACTURED BY GRANITE INDUSTRIES

# **ALUMINUM CONVERTIBLE HAND TRUCK**

**INSTRUCTION MANUAL**



67393

Revised: JULY 2018

## CONTENTS

Specs .....	3
Parts Diagram .....	4
Assembly .....	5

## TOOLS NEEDED

- 9/16" Wrench
- Socket Wrench with 9/16" Socket
- Needle Nose Pliers
- Box Cutters / Utility Knife

## MADE IN THE USA GUARANTEE



Our American made products are engineered, manufactured and assembled in Archbold, OH using USA made steel.



*Expect more. get more.*  
FROM GRANITE INDUSTRIES

- Exceptional quality and service on every single product.
- Professional grade designs by our in house engineers.
- Industry leading warranties.
- Family owned and operated in the USA.

To view more products from  
American Cart & Rack  
scan the QR code with your phone  
or visit [AmericanCartAndRack.com](http://AmericanCartAndRack.com)



## WARRANTY

3 Year Limited Warranty. Carts, excluding any finishes, casters and wheels are warranted for three (3) years from date of original purchase. Casters and wheels are warranted for 90 days from date of original purchase. We will repair, without charge, any defect due to faulty material or workmanship. These warranties do not cover failures due to abuse, misuse, improper installation, accidental damage or when repairs or modifications have been made or attempted to be made by anyone other than Granite Industries. Any defective products that meet warranty specifications and Granite Industries approval, may be returned to the factory to be repaired or replaced free of charge. (Granite Industries will pay to ship replacement item(s) to the customer; however the customer is responsible for shipment of products to the factory.) This remedy is the sole remedy in contract, tort or otherwise, and Granite Industries is not liable for incidental, consequential or special damages. These warranties give you specific legal rights, and you may have other rights which vary from state to state. Should you have any questions, contact Granite Industries (Proof of purchase may be required).



**GRANITE  
INDUSTRIES**

**Customer Service  
877-447-2648  
M-F, 8am - 5pm EST**

# SPECS

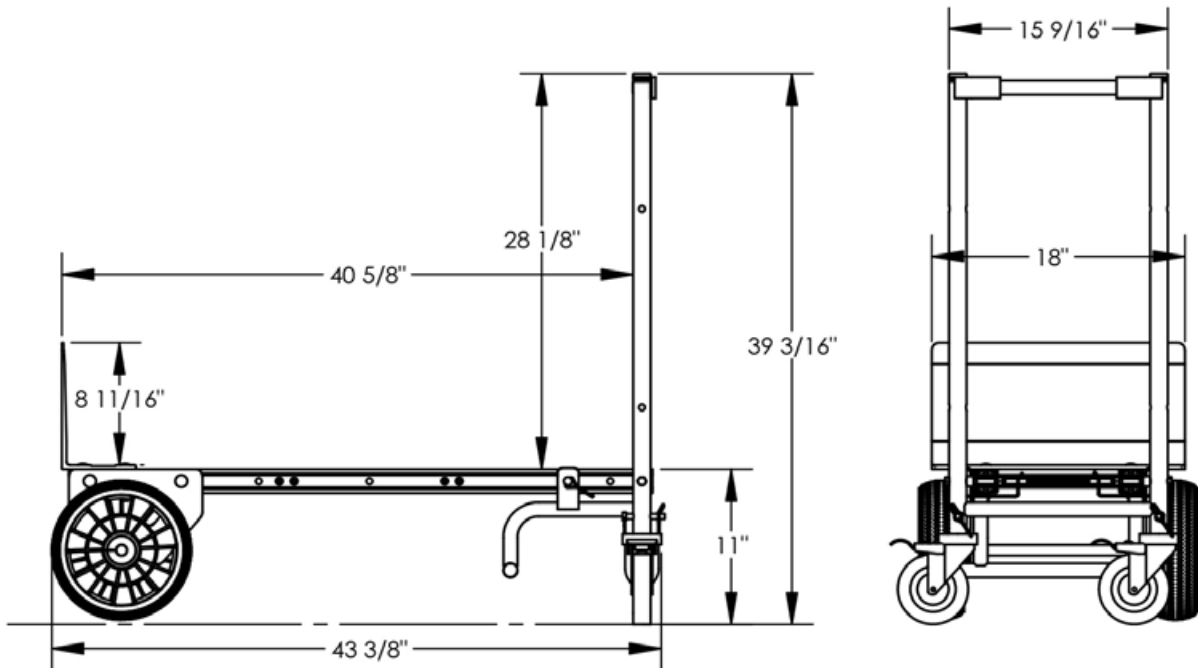
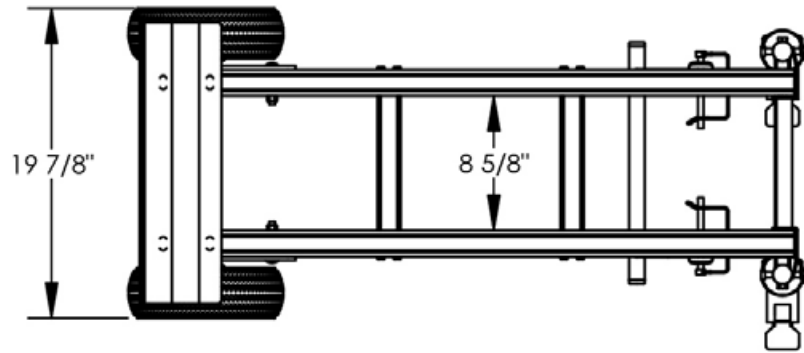

<b>Hand Truck:</b>	<b>W:</b> 20"	<b>D:</b> 20"	<b>H:</b> 52"
<b>Platform Cart:</b>	<b>W:</b> 20"	<b>D:</b> 44"	<b>H:</b> 39"
<b>Foot Plate:</b>	<b>W:</b> 18"	<b>D:</b> 9"	
<b>Weight:</b>	44 lbs.	<b>Capacity:</b>	600 lbs.

# PARTS DIAGRAM

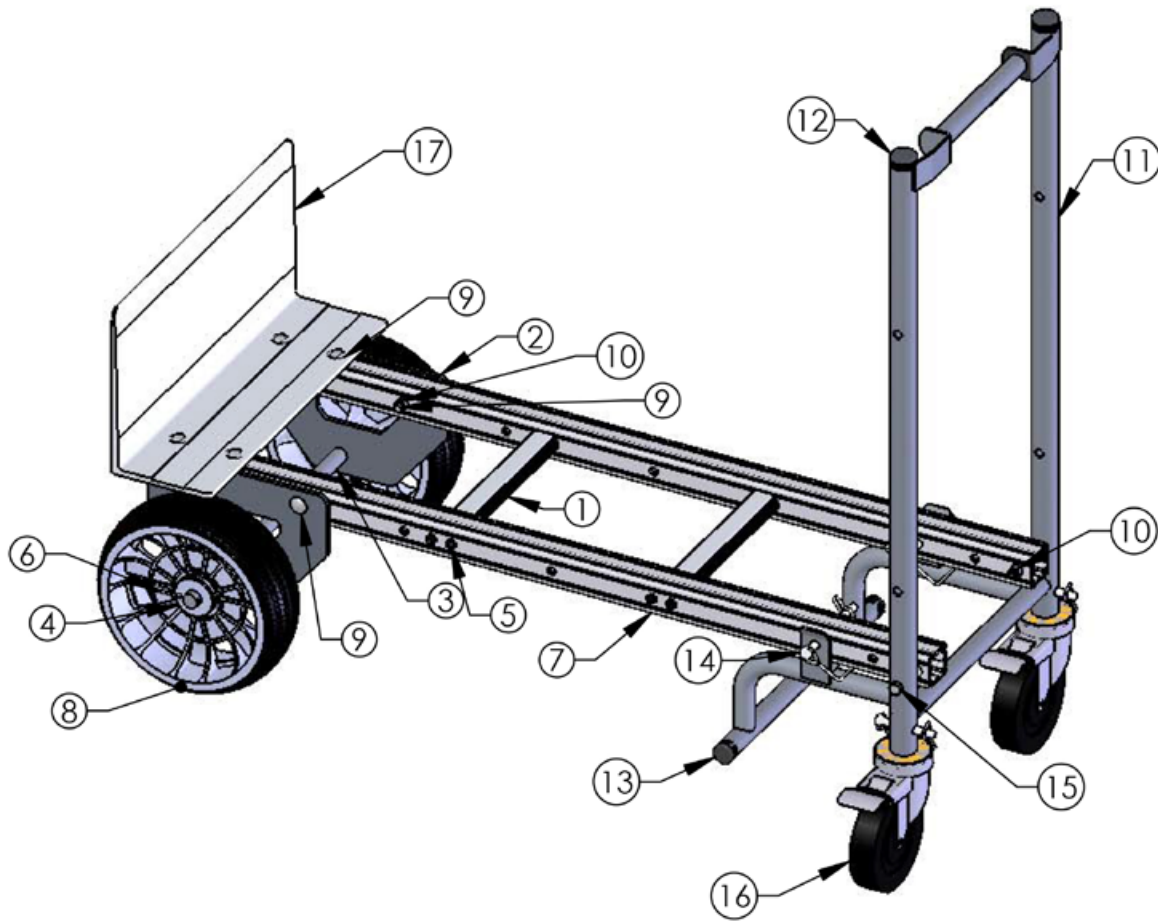

ITEM NO	QTY	PART NO	DESCRIPTION	
1	2	MI-13-0813	Cart Body Cross Member	
2	2	MI-08-1680	D Bracket	
3	1	MI-04-0704	Axle 3/4" x 18 3/8"	
4	6	PI-01-0451	3/4" Washer	
5	8	PI-01-0424	3/4" Slotted Hex Washer	
6	2	PI-01-0226	3/8" Cotter pin - 1-1/4"L	
7	2	MI-13-0845	Outer Cart Frame	
8	2	PI-06-0123	10" Offset Plastic Hub Wheel	
9	8	PI-01-0115	3/8" Carriage Bolt 2-1/2" L	
10	10	PI-01-0019	3/8" Lock Nut	Use a 9/16" wrench / socket
11	1	MI-12-5765	Convertible Handle	
12	2	PI-04-0036	Cap Plug 1-1/4"	
13	2	PI-04-0035	Cap Plug 1"	
14	2	06015	4" Snap Pin	
15	2	PI-01-0169	3/8" Hex Bolt - 4"L	
16	2	38057	5" Caster	
17	1	MI-13-0836	Foot Plate	

## STEP 1: FOOT PLATE ASSEMBLY

COMPONENTS		
ITEM NO	QTY	DESCRIPTION
8	4	3/8" Carriage Bolt - 2-1/2" L
6	4	3/8" Locknut
13	1	Footplate
	1	Cart Frame

TOOLS	
9/16" Socket or 9/16" Wrench	

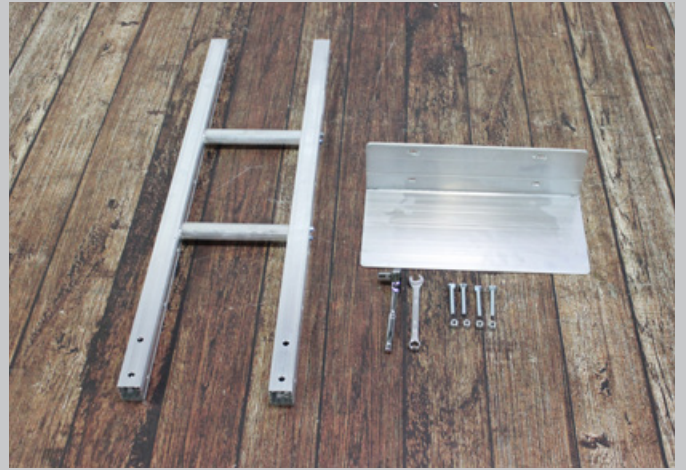

**1** Center the foot plate onto the cart frame and align the holes on both. Insert bolts from front to back into each of the holes.



**2** Thread a lock nut onto each bolt and finger tighten.



**3** Finish tightening all of the bolts with a 9/16" socket wrench.



**✓ CHECK POINT**  
Your cart should look like this.  
If so, continue onto the next step.

## STEP 2: D BRACKET ASSEMBLY

COMPONENTS		
ITEM NO	QTY	DESCRIPTION
2	2	D Bracket
8	4	3/8" Carriage Bolt - 2-1/2" L
6	4	3/8" Locknut

TOOLS		
9/16" Socket or 9/16" Wrench		

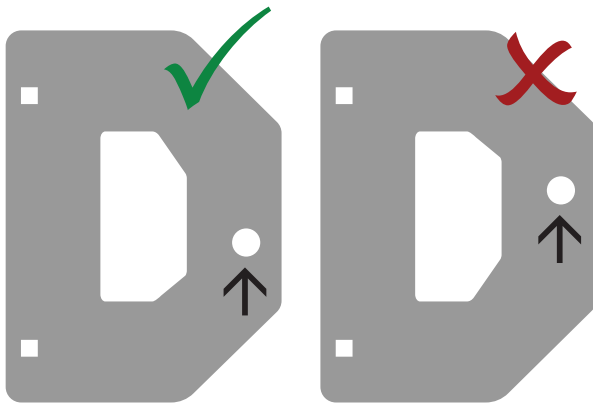

**1** Make sure the D brackets are installed with the hole for the axle towards the bottom.



**2** Lay your cart face down. Place a D bracket on the outside of the cart frame. Insert a bolt through the square hole on bracket and frame. Repeat for the 2nd square hole.



**3** Install a lock nut on the bolt. Use a 9/16" wrench to tighten. Repeat for the other D bracket.

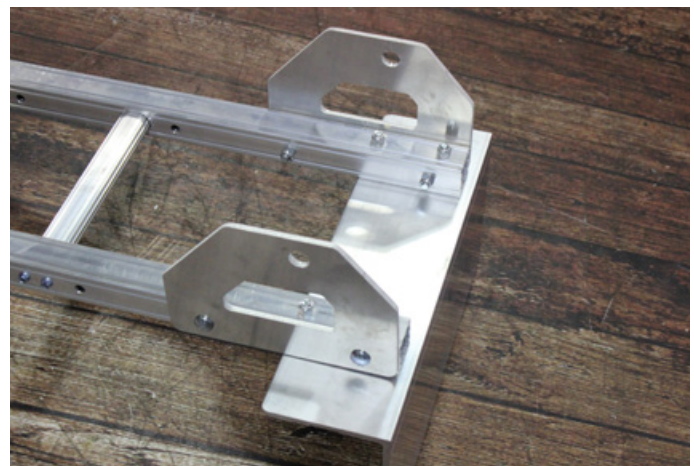

**CHECK POINT**  
 Your cart should look like this. If so, continue onto the next step.

## STEP 3: WHEEL ASSEMBLY

COMPONENTS		
ITEM NO	QTY	DESCRIPTION
3	1	Axle 3/4" x 18 3/8"
4	6	3/4" Washer
7	2	3/8" Cotter pin - 1-1/4"L
11	2	10" Offset Plastic Hub Wheel

TOOLS		
Pliers or Needle Nose Pliers		



**1** Slide the axle through the round holes on the D bracket.



**2** Slide 2 washers onto the axle, followed by one of the tires. Make sure the offset side of the tire is going towards the cart body.



**3** Place a third washer onto the axle.



**4** Insert a cotter pin, and using a needle nosed pliers, bend both sides outward to secure in place. Repeat steps 1-4 for the other wheel.

## STEP 4: HANDLE & CASTER ASSEMBLY

COMPONENTS		
ITEM NO	QTY	DESCRIPTION
10	2	3/8" Lock Nut
11	1	Convertible Handle
14	2	4" Snap Pin
15	2	3/8" Hex Bolt - 4"L
16	2	5" Caster

  

TOOLS		
9/16" Socket		
9/16" Wrench		



# 1

Lay the cart down and position the convertible handle under the cart.

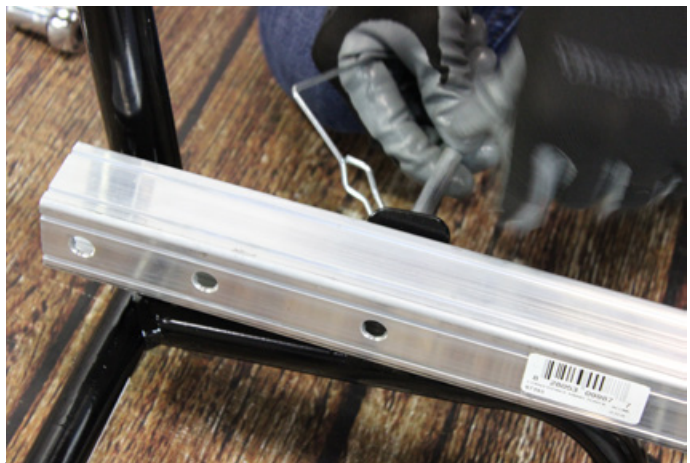

# 2

Pin the convertible handle into place to help stabilize the cart until the bolts are secured.



# 3

Insert the bolts from the outside of the cart towards the inside. Install a lock nut and tighten down using a socket wrench, but not so tight the handle doesn't rotate.



# 4

Stand the cart upright and insert the casters into the convertible handle. Use a snap pin to secure them in place.